

## PM 4-300 / PM 4-300V



### Passive deflecting mirrors for 4-beam Multiple light beam safety devices

The PM 4-300 and PM 4-300V are each designed for use as the deflecting mirror unit for ROBUST Multiple light beam safety devices RRT 44 and RRT 24. The integrated, optically aligned mirror system ensures simple mounting and alignment, substantially decreasing the start-up time as compared with single mirrors. Used in combination with ROBUST Multiple light beam safety devices, **PM 4-300** is suited for sensing zone widths of up to 2,5 m. The integrated mirror system is able to tolerate deviations in vertical alignment.

With its expanded mirror system, the **PM 4-300V** used in combination with ROBUST Multiple light beam safety devices can handle sensing zone widths of up to 8 m. The V-mirror system tolerates not only vertical but also axial deviations in alignment.

### Areas of application

In combination with 4-beam Multiple light beam safety devices ROBUST RRT 24 and RRT 44 for safeguarding danger zones around automated production cells and for safeguarding access to industrial robots.



### Leuze electronic GmbH + Co. KG

Liebigstrasse 4  
82256 Fuerstenfeldbruck / Germany  
Phone +49 8141 5350-0  
Telefax +49 8141 53 50-190  
info@leuze.de  
www.leuze.com

### Advantages

- Easy alignment due to integrated, optically aligned mirror system
- Ranges of up to 2,5 m (PM 4-300) or 8 m (PM 4-300V)
- Enclosed profile housing prevents contamination of and damage to the mirrors
- Adjustable M6 sliding brackets for fast and easy mounting
- PM 4-300 tolerates vertical deviations in alignment
- PM 4-300V tolerates both vertical and axial deviations in alignment

### Dimensional Drawings

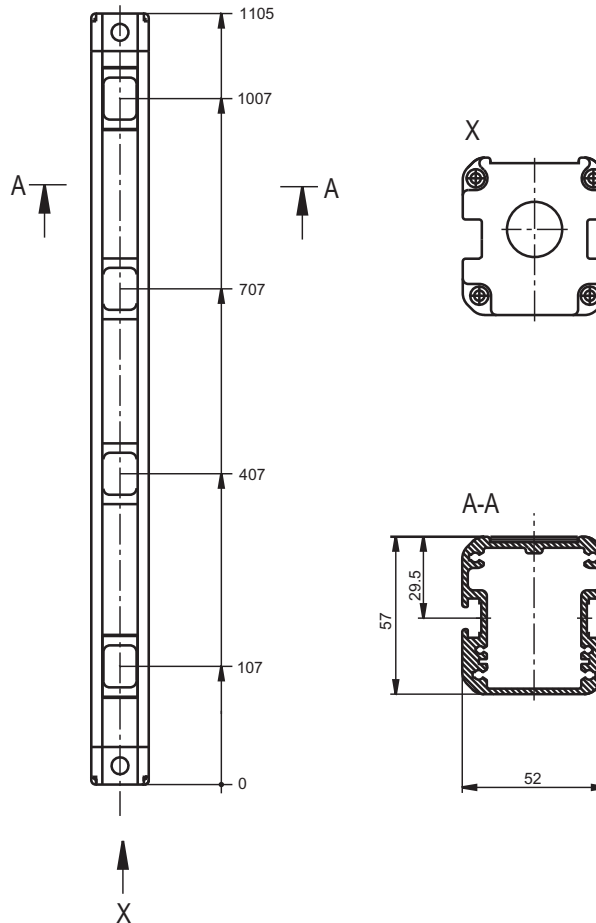

### Order Details

| Type                                | Art. no.   |
|-------------------------------------|------------|
| Passive deflecting mirror PM 4-300  | 50029570 * |
| Passive deflecting mirror PM 4-300V | 909663 *   |

\* 2 standard mounting brackets, 2 M6 sliding nuts and screws included

### Accessories

| Type  | Art. no. |
|---|----------|
| Swivelling mount with absorption of vibration (2 pieces per unit necessary) | 560300   |
| Mounting column UDC-1000-S1 (height 1060 mm)                                | 549827   |
| Mounting column UDC-1300-S1 (height 1360 mm)                                | 549828   |
| Mounting column UDC-1600-S1 (height 1660 mm)                                | 549814   |
| Mounting column UDC-1900-S1 (height 1960 mm)                                | 549829   |